



INSTALLATION GUIDELINES

Composite Vapor Barrier

STEP 2: Unroll, Overlap And Tape The Seam

Please place the geo-textile (black color) side facing up. Seams and/or joints can be joined using Barrier-Bac White Bond Tape. Two VBC-350 sheets should be overlapped six inches side-to-side and end-to-end.

Note: In case project design specifications require or it is needed to use additional adhesive to secure Barrier-Bac Seam Tape, we recommend using 3M™ Scotch-Weld™ HoldFast 70 Cylinder Spray Adhesive Clear to apply on the geo-textile surface overlap prior to tape application.

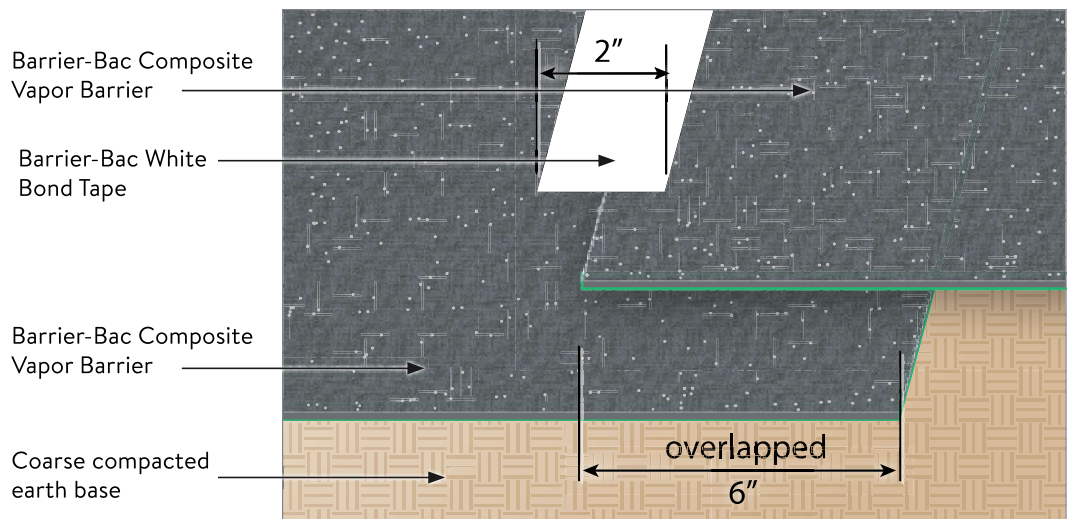

STEP 3: Pour The Concrete

Inspect all seams, penetration and damaged areas and make sure they are well sealed or patched. (See Step 7 & 8: Seal Penetrations and Step 9: Patch Damage) After seal all penetrations and patch all damaged areas, pour the concrete on top of Barrier-Bac Vapor Barrier

