

STEP 4: Pipe Penetration Details

See the details about making pipe boots at Step 7: Seal Penetrations. For square penetrations, see Step 8: Square Penetrations

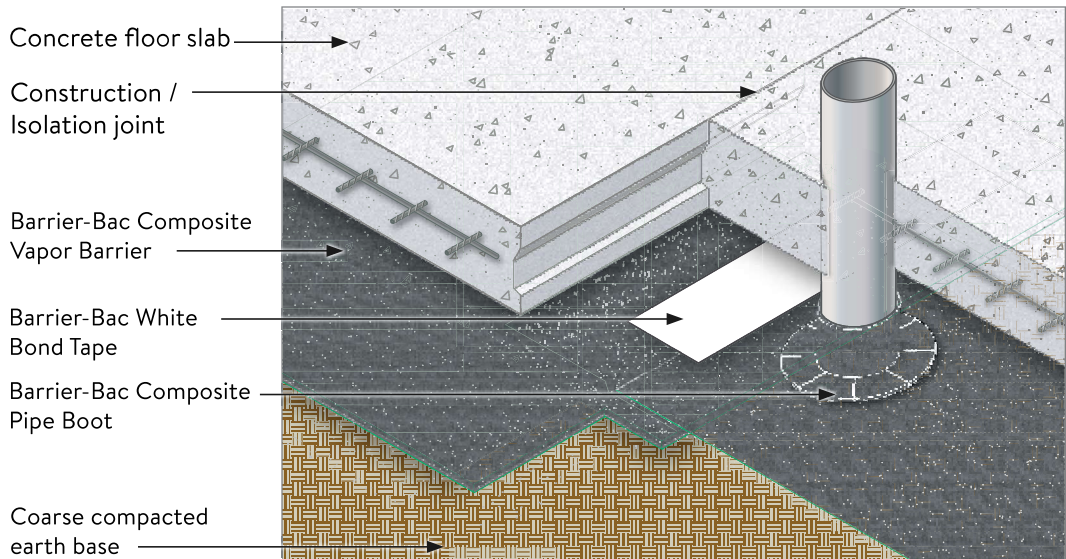

STEP 5: On Top of The Footing

When vertical wall is involved, please place the membrane butt end on top of the footing and up against the vertical wall. This placement method will provide the needed protection from outside moisture following construction completion.

